



Shanghai Solar Energy S&T Co.,Ltd.

About Shanghai Solar Energy S&T Co.,Ltd.

Officially registered in January 2000, Shanghai Solar Energy S&T Co.,Ltd.
The company has built more than 300 photovoltaic power stations

Space Photovoltaic Industry Chain

As an important unit of Space photovoltaic industry chain,
relying on aerospace technology advantage.

Competitive Strength

SSEC has abundant experience in photovoltaic production
It has researched and developed large area high-power BIPV modules.

Features

- Unique design of the aluminum alloy frame
 - Complete & Compact seal design
 - High light transmission glass
- These details to ensure the high quality of our products.

Corporate Culture

Integrity , Innovation , Harmony.

Warranties

- 5-year limited product warranty*
- Limited power warranty*: 10 years at 90% of the nominal rated power output, 25 years at 80% of the nominal rated power output

Qualifications and Certificates

IEC 61215 Edition 2, IEC 61730 Class A, UL1703, CE, ISO 9001, ISO14000, ISO18001

*Design and specifications are subject to change without notice.

Add: No.555 Shen Nan Road, Xin Zhuang Industrial Zone, Shanghai, P.R. China, 201108

Tel: 86-21-64895099 Fax: 86-21-64898715

http: //www.ssec-solar.com E-mail: webmaster@ssec-solar.com

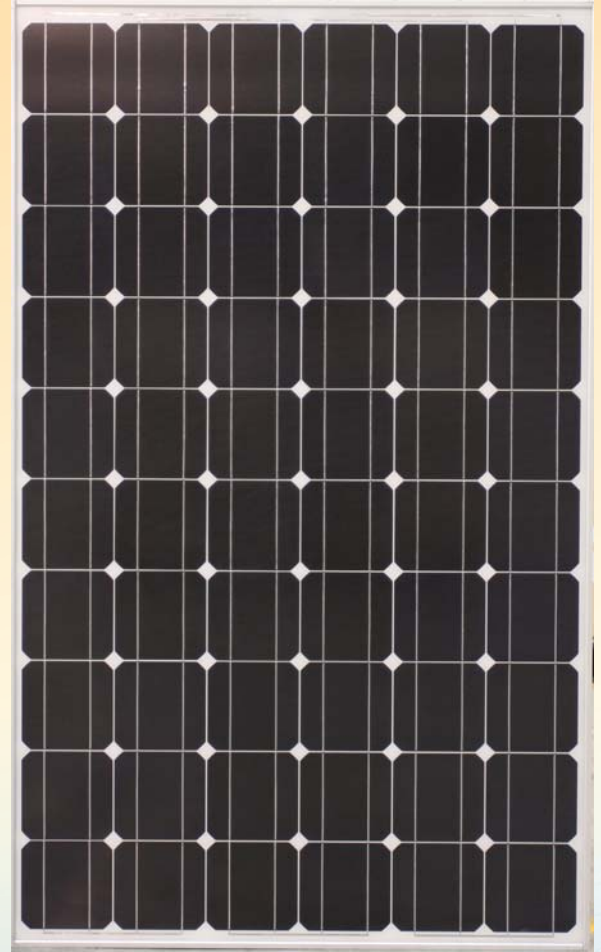

- Qualified, IEC 61215
- Safety tested, IEC 61730
- Periodic Inspection



STC	S-225C	S-230C	S-235C	S-240C	S-245C
Nominal peak power	225W	230W	235W	240W	245W
Open circuit voltage	37.1V	37.3V	37.5V	37.7V	37.8
Max. power voltage	29.3V	29.7V	30.1V	30.4V	30.8V
Short circuit current	8.20A	8.27A	8.33A	8.45A	8.55A
Max. power current	7.68A	7.75A	7.81A	7.90A	7.96A
module efficiency	13.8%	14.1%	14.4%	14.7%	15.0%
Power output tolerances	±3%				
Max. system voltage	1,000 VDC				
Max.series fuse rating	15A				
Operating temperature	- 40°C to + 85°C				
*Electrical parameters at STC (1,000 W/m ² , 25°C, AM 1.5 according to EN 60904-3)					

NOCT	S-225C	S-230C	S-235C	S-240C	S-245C
Nominal peak power	160W	164W	168W	171W	175W
Open circuit voltage	33.8V	33.9V	34.1V	34.3V	34.4V
Max. power voltage	25.8V	26.1V	26.5V	26.8V	27.1V
Short circuit current	6.64A	6.70A	6.75A	6.84A	6.93A
Max. power current	6.22A	6.28A	6.33A	6.40A	6.45A
NOCT	46°C ± 2°C				
*Electrical parameters at NOCT (800 W/m ² , 20°C, AM 1.5 according to EN 60904-3)					

Temperature coefficients	
γ_{Pm}	-0.47%/K
α_{Isc}	0.056%/K
β_{Voc}	-0.34%/K

Mechanical parameters	
Module dimension	1650*992*46(mm)
Weight	23.0kg
Max. wind Load	2400pa
Max. snow Load	5400pa
Cell dimension	156*156
Cell type	60(6*10) / Monocrystalline
Packing method	546pcs/40'HC 390pcs/40'

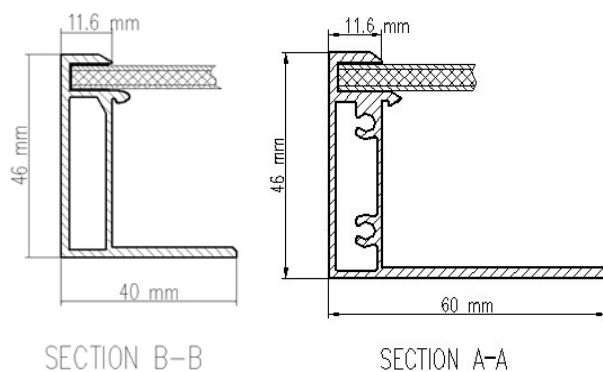
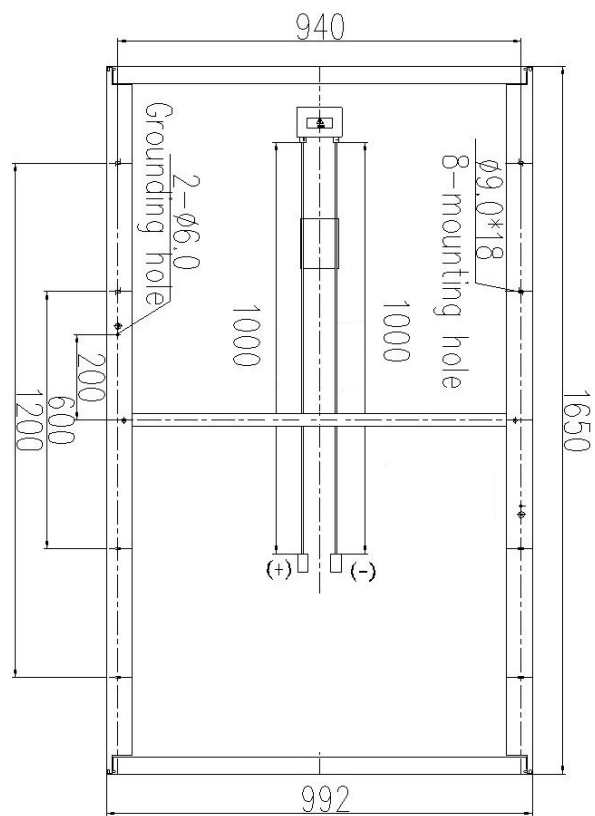

Current, power VS voltage characteristics (solar irradiant:100%, 80%, 50%)

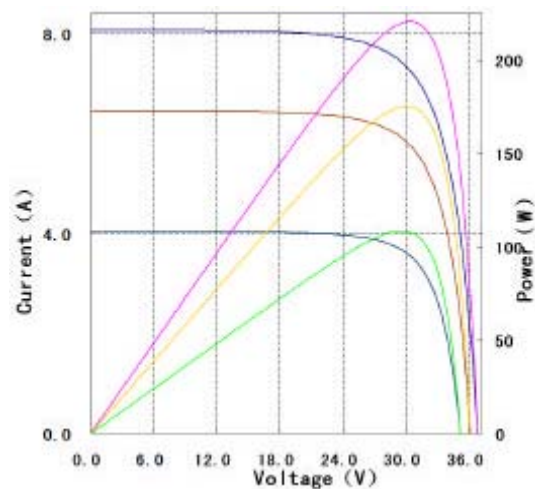

*Design and specifications are subject to change without notice.

Add: No.555 Shen NanRoad, Xin Zhuang Industrial Zone, Shanghai, P.R. China, 201108

Tel: 86-21-64895099 Fax: 86-21-64898715

http: //www.ssec-solar.com E-mail: webmaster@ssec-solar.com